

RT-2015/2016/2115/2116
Fanless Touch POS Terminal
User Manual



Package Contents

- ✓ RT-2015 15" fanless touch terminal or
RT-2016 15.6" fanless touch terminal or
RT-2115 15" fanless touch terminal or
RT-2116 15.6" fanless touch terminal (x 1)
- ✓ Power adapter (x 1)
- ✓ Power cord (x 1)
- ✓ User manual (x 1)

16950900010 Ver. A0

<http://www.posiflex.com>

Views of RT-2015/2016/2115/2116

Front View

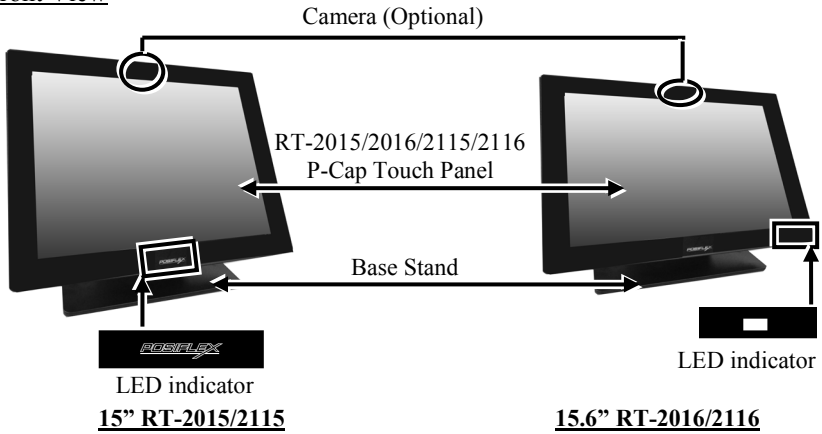

Rear View



Bottom View

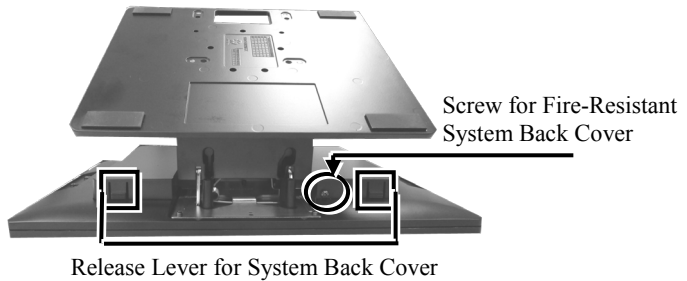

Left-Side View

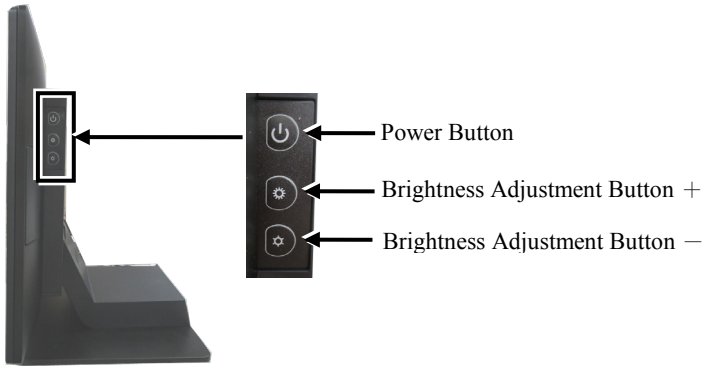

View of I/O Interface of RT-2015/2016

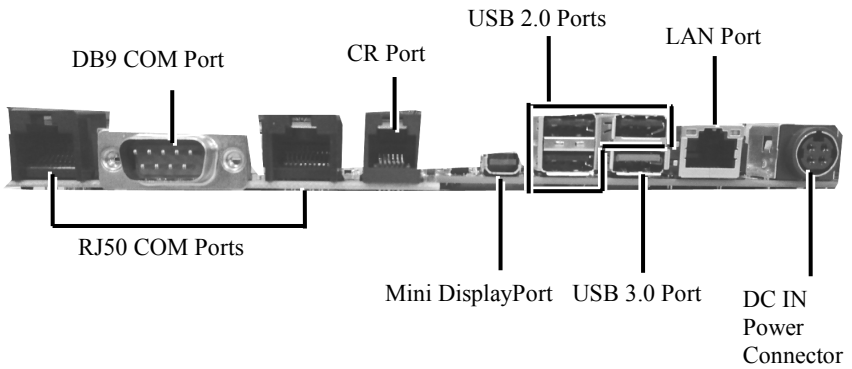

View of I/O Interface of RT-2115/2116

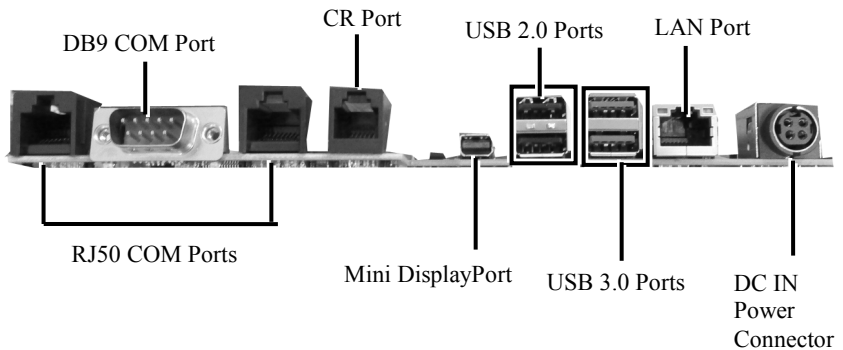

Positioning your POS for a Perfect Viewing Angle

Steady the base with one hand, and then tilt the screen in the direction shown by the arrow in the figure. Please do NOT press on the LCD panel while setting up the tilt angle.



Installing Power Adapter and Cables

The following provides instructions required to install your cables.

1. Lay the terminal with its rear facing towards you and tilt the screen all the way down.



2. Remove the system back cover.
 - 2.1 If the system back cover is fire-resistant, first locate the screw as indicated in the figure, and then remove it.

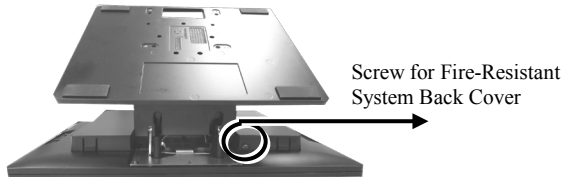

- 2.2 Hold down the release lever at the bottom of the system back cover and then pulling the cover outwards.



3. To remove the stand cover from the base, grab the top side of the cover, (1) lift the stand cover up gently, (2) pull it at a 45 degree angle, and then (3) slide it in the horizontal direction shown by the arrow.

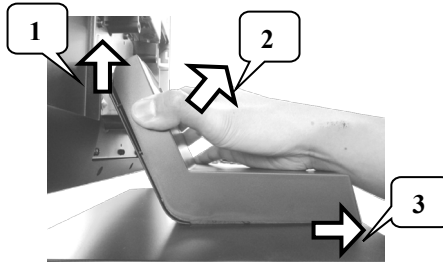

4. Connect the connector of the power adapter to the DC-IN power jack. If necessary, properly insert other cables into the correct port.



5. **Neatly arrange the cables.** Locate the cable holder inside the base as shown in the figure. Push down the lever to release it from the hook, pass the cable through cable holder, and then press down the lever again to lock it onto the hook.

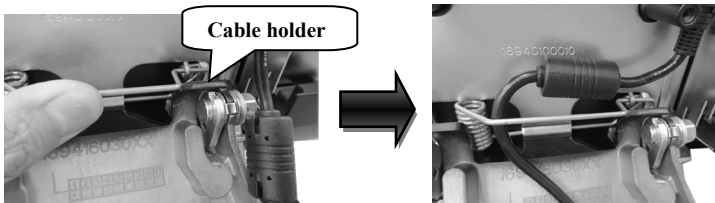

6. Make sure the cord can be held into place and passed through the cable exit after sliding back the stand cover.

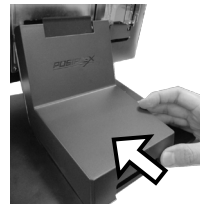

7.

- 7.1 Place back the system back cover. Make sure it is well locked into place with a click sound.



- 7.2 For the fire-resistant system back cover, please insert another screw into the screw hole indicated in the figure, and secure it.

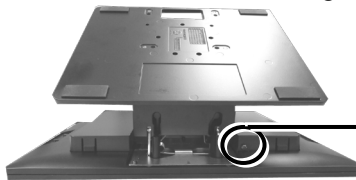

Screw for Fire-Resistant System Back Cover

8. Make sure the cable could be pulled out of the cable exit from the bottom of the base.



Installing Optional Upgrade Kits and Peripherals

RT-2015P/2016P/2115P/2116P is an expandable model which allows you to upgrade its own capacity by additionally installing multiple peripheral devices, such as magnetic stripe reader (MSR), fingerprint or iButton sensors, and 2nd rear-mount POS monitor, according to your preference. The following will give you brief instructions on how to expand on your current POS system with these optional upgrade kits. Before proceeding with the installation of peripherals, please make sure the POS system is completely shut down to prevent damage.

➤ Installing Side Mount Upgrade Kits

Located at left side on the back of your system unit, side mount compartment is mainly used for installation of side-mounted equipment, such as magnetic stripe reader. For detailed installation instructions, please refer to the user manual specific to the device which you intend to mount onto the terminal.



➤ **Installing Rear-Mount POS Monitor**

RT-series POS terminal also allows you to additionally install rear-mount POS monitor to expand its functionality. Regarding the step-by-step instructions which aim to help you mount it onto your POS system, Please refer to the user manual specific to the device you intend to install.

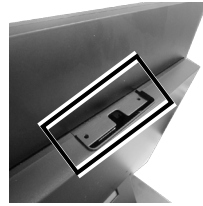

➤ **Installing PoweredUSB or USB Hub**

Please go through the below steps to complete the installation of PoweredUSB or USB hub.

1. After tilting the screen all the way down, remove the system back cover.
 - 1.1 If the system back cover is fire-resistant, first locate the screw as indicated in the figure, and then remove it.

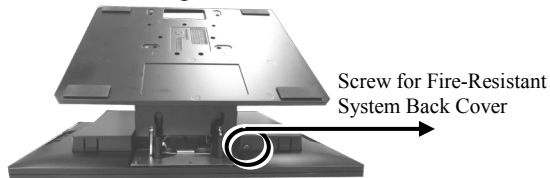

- 1.2 Hold down the release lever at the bottom of the system back cover and then pulling the cover outwards



2. To remove the stand cover from the base, grab the top side of the cover, (1) lift the stand cover up gently, (2) pull it at a 45 degree angle, and then (3) slide it in the horizontal direction shown by the arrow.

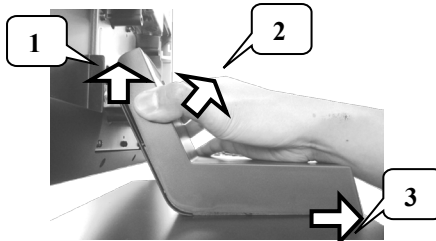

3. Align the two screw bolts at the bottom of PoweredUSB or USB hub with rail slots in the base.

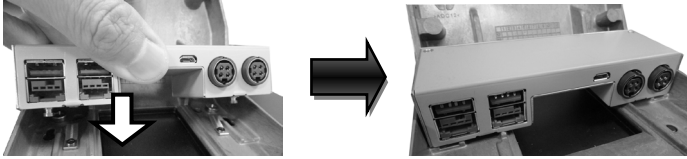

4. Push PoweredUSB or USB hub in the direction shown by the arrow to lock it into place.



To remove the PoweredUSB or USB hub from the rail slots, press down the hubs first and then push it outwards.

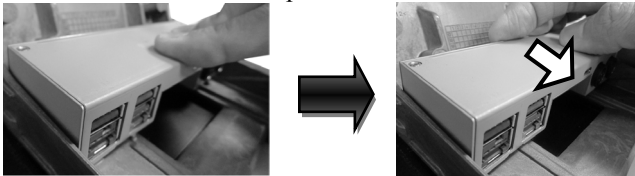

5. Install power adaptor extension cable, USB cable, and power adaptor for **PoweredUSB hub**.

- 5.1 Insert one end of the provided power adaptor extension cable to DC Input port of PoweredUSB hub and another end to DC-in power jack of the terminal.



- 5.2 Insert mini-USB connector of the USB cable to PoweredUSB hub and another end to USB3.0 port of the terminal.



- 5.3 Connect the connector of the power adapter to DC Output port of PoweredUSB hub, and the other end to the electrical outlet.



6. To Install USB cable for **USB hub**, Plug Type-A connector of USB cable to USB Port of USB hub and the other end of USB cable to USB3.0 port of the POS terminal.

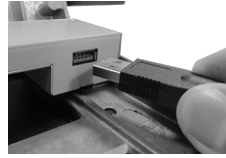

7. Neatly arrange your cable and then slide back the stand cover.



8. .
8.1 Place back the system back cover. Make sure it is well locked into place with a click sound



- 8.2 For the fire-resistant system back cover, please insert another screw into the screw hole indicated in the figure, and secure it.

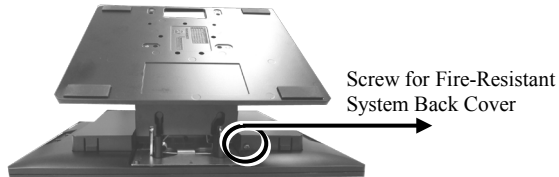

Status LED Indicator

LED status indicator, which is located at the bottom edge of the LCD panel, is mainly responsible for notifying users of the current system status by emitting various LED signals. In the chart provided below, it describes all the possible LED status as a quick reference.

15" RT-2015/2115

LED Status	Description
Off	System power OFF
Green	System standby
Blue	System power ON

15.6" RT-2016/2116

LED Status	Description
Off	System power OFF
Orange	System standby
Blue	System power ON

Powering ON/OFF RT-2015/2016/2115/2116

Power ON RT-2015/2016/2115/2116

Press down the power button to power on the POS.

Power OFF RT-2015/2016/2115/2116

In most cases, press the power button of the POS to power the system off. If the terminal fails to turn off the machine for unknown reasons, please be advised to hold the power button more than 10 seconds to force a shutdown of the system.

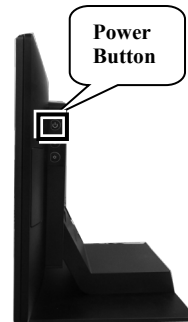

Installing an Operating System

You are highly advised not to install an operating system on RT-2015/2016/2115/2116 without professional instructions. Improper installation could lead to system malfunction or failure. Please contact with your dealers about the issues of operating system installation.

Performing System Recovery

For RT-2015/2016/2115/2116 model with preloaded operating systems, Recovery DVD which includes useful utilities will be provided in the package to assist you in efficiently restoring or repairing your damaged system. However, you are not encouraged to recover your system without the help of system integrators. Please be advised to contact your service center for further assistance with system recovery.

Operation Environment

To prevent RT-2015/2016/2115/2116 from overheating, it is suggested to position your terminal in a well-ventilated working environment. In doing so, please be advised to keep the POS terminal at least 25mm away from other devices to ensure the machine is properly cooled down and functioning normally.

Specifications

RT-2015/2016

	RT-2015	RT-2016
CPU	Intel Bay Trail-D Intel Celeron - J1900 (2.0 GHz, Quad-Core, 10W TDP)	
System Memory	DDR3L, SO-DIMM socket x 1, max. 8GB	
Storage Device	SATA Storage x 2	
Power Supply	12V / 60W, can be upgraded to 150W while adopting PoweredUSB module	
LCD Panel	15" TFT LCD with LED backlight	15.6" TFT LCD with LED backlight
LCD Resolution	1024 x 768	1920 x 1080
Touch Sensor	P-CAP touch	
Serial Port	3 ports, DB9 x 1 + RJ-50 x 2	
USB Port	4 ports, USB3.0 x 1 + USB2.0 x3 Additional USB port replicator (USB2.0 x 4, installed in base stand)	
LAN Port	10/100/1000 Mb x 1	
Display Port	<ul style="list-style-type: none"> ● eDP connector (internal header, support 15.6" LCD) ● VGA + USB + 12V (internal header, supporting 2nd monitor 9.7"/10.1") ● 1 x Mini DP port (on I/O plate) 	
CR Port	1 port, controlling 2 CR	
Audio Port	Internal 2W speaker x 1	
Extension Slot	M.2 slot x 1	
vPro	N/A	
TPM	N/A	
RAID	N/A	
Dimension (W x V x D in mm)	Main Unit : 368 x 292 x 46.6 with base stand : 368 x 325 x 207	Main Unit : 402 x 251 x 41.2 with base stand : 402 x 297 x 207
Environmental Requirements	Operating : 0°C ~ 40°C, 20%RH - 90%RH (with HDD) 0°C ~ 50°C, 20%RH - 90%RH (with SSD) Storage : -20°C ~ 70°C, 10%RH - 90%RH	

Regulation Rules	FCC/CE
Attachment	
RA-101	Slim MSR attachment for RT series
RA-103	iButton (or RFID) with one USB port attachment for RT series
RA-104	2D scanner attachment for RT series
RA-301	3-in-1 MSR + Fingerprint Sensor + 2D scanner attachment for RT series
LM/TM-4010	9.7" 2nd display for RT series terminal
LM/TM-4011	10.1" 2nd display for RT series terminal
PU-460	PoweredUSB module to support 12V and 24V Powered USB ports
RT-560	USB port replicator (USB2.0 x 4, installed in base stand)

RT-2115/2116

	RT-2115	RT-2116
CPU	Intel Apollo Lake SoC Intel Celeron - N3350 (2.4 GHz, Dual-Core, 6W TDP)	
System Memory	DDR3L, SO-DIMM socket x 1, max. 8GB	
Storage Device	SATA Storage x 2	
Power Supply	12V / 60W, can be upgraded to 150W while adopting PoweredUSB module	
LCD Panel	15" TFT LCD with LED backlight	15.6" TFT LCD with LED backlight
LCD Resolution	1024 x 768	1920 x 1080
Touch Sensor	P-CAP touch	
Serial Port	3 ports, DB9 x 1+ RJ-50 x 2	
USB Port	4 ports, USB3.0 x 2 + USB2.0 x 2 Additional USB port replicator (USB2.0 x 4, installed in base stand)	
LAN Port	10/100/1000 Mb x 1	
Display Port	<ul style="list-style-type: none"> ● eDP connector (internal header, supporting 15" and 15.6" LCD panel) ● VGA + USB + 12V (internal header, support 2nd monitor 9.7"/10.1") ● 1 x Mini DP port (on I/O plate) 	
CR Port	1 port, controlling 2 CR	
Audio Port	Internal 2W speaker x 1	

Extension Slot	M.2 slot x 1	
vPro	N/A	
TPM	N/A	
RAID	N/A	
Dimension (W x V x D in mm)	Main Unit : 368 x 292 x 46.6 with base stand : 368 x 325 x 207	Main Unit : 402 x 251 x 41.2 with base stand : 402 x 297 x 207
Environmental Requirements	Operating : 0°C ~ 40°C, 20%RH - 90%RH (with HDD) 0°C ~ 50°C, 20%RH - 90%RH (with SSD) Storage : -20°C ~ 70°C, 10%RH - 90%RH	
Regulation Rules	FCC/CE	
Attachment		
RA-101	Slim MSR attachment for RT series	
RA-103	iButton/RFID) with one USB port attachment for RT series	
RA-104	2D scanner attachment for RT series	
RA-301	3-in-1 MSR + Fingerprint Sensor + 2D scanner attachment for RT series	
LM/TM-4010	9.7" 2nd display for RT series terminal	
LM/TM-4011	10.1" 2nd display for RT series terminal	
PU-460	PoweredUSB module to support 12V and 24V Powered USB ports	
RT-560	USB port replicator (USB2.0 x 4, installed in base stand)	

※ The product information and specifications are subject to change without prior notice. To get the detailed information on the RT-2015/2016/2115/2116, please check this model from Posiflex Global Website

<MEMO>

<MEMO>